

**CI22 Series 2.50mm(.098") Pin Header**

- ⊙ With locking slot and Pin Kinked
- ⊙ Mate with CI22 housing

**Construction**

- ⊙ Insulator: Nylon 66 UL 94V-0, Color Nature
- ⊙ With Tin-lead plated 0.64mm square pin



:E159616

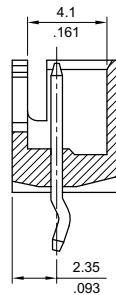
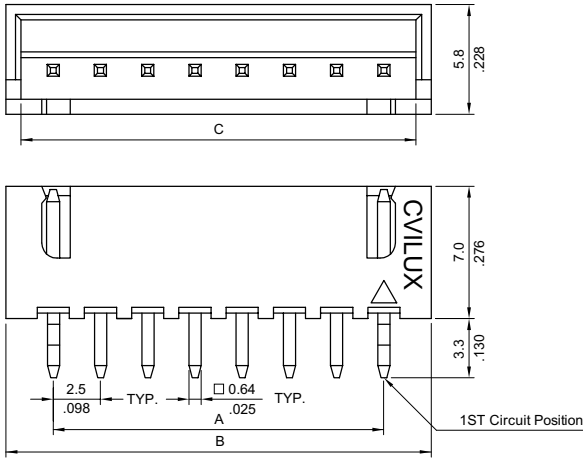

Circuits	Dimension		
	A	B	C
2	2.50(.098)	7.5(.295)	6.0(.236)
3	5.00(.197)	10.0(.394)	8.5(.335)
4	7.50(.295)	12.5(.492)	11.0(.433)
5	10.00(.394)	15.0(.591)	13.5(.531)
6	12.50(.492)	17.5(.689)	16.0(.630)
7	15.00(.591)	20.0(.787)	18.5(.728)
8	17.50(.689)	22.5(.886)	21.0(.827)
9	20.00(.787)	25.0(.984)	23.5(.925)
10	22.50(.886)	27.5(1.083)	26.0(1.024)
11	25.00(.984)	30.0(1.181)	28.5(1.122)
12	27.50(1.083)	32.5(1.280)	31.0(1.220)
13	30.00(1.181)	35.0(1.378)	33.5(1.319)
14	32.50(1.280)	37.5(1.476)	36.0(1.417)
15	35.00(1.378)	40.0(1.575)	38.5(1.516)
16	37.50(1.476)	42.5(1.673)	41.0(1.614)
17	40.00(1.575)	45.0(1.772)	43.5(1.713)
18	42.50(1.673)	47.5(1.870)	46.0(1.811)
19	45.00(1.772)	50.0(1.969)	48.5(1.909)
20	47.50(1.870)	52.5(2.067)	51.0(2.008)

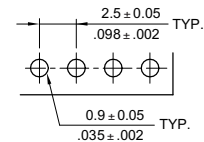
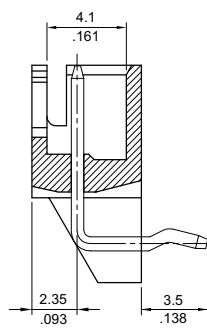
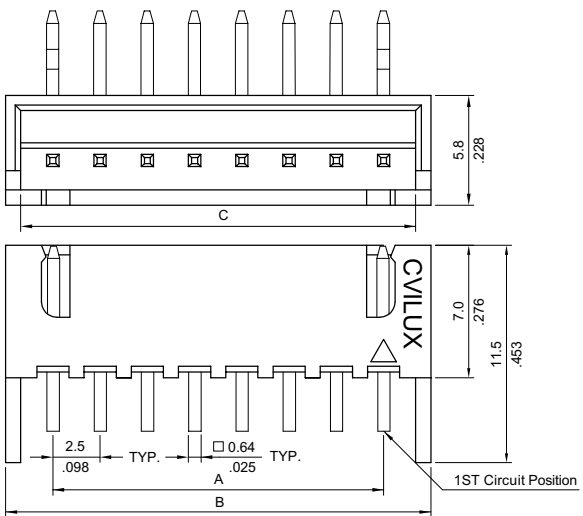

Recommended P.C. Board Layout

**Ordering Code**

① **CI22**    ② **20**    ③ **P**    ④ **1**    ⑤ **V**    ⑥ **K0**

① Series No.

② No. of Circuits: 02 to 20

③ P= Pin header

④ Plating code:

1= Tin-lead over Nickel

⑤ Type: V= Straight

H= Right angle

⑥ Other options:

00= Without Pin Kinked

K0= With Pin Kinked (Standard)

\*Special option Consult manufacturer